

佛山市盈富达电机有限公司

样品确认书

SPECIFICATION FOR APPROVAL

电机型号：D3045D24-Q227

编号：2402271

MODEL:

客户料号：1.02.001.006 (GM9)

CUSTOMER NO.:

版本:A

REV:

共： 5 页 （含本页）

客户承认栏
CUSTOMER APPROVAL

确 认 APPROVED BY	审 核 CHECKED BY	制 作 PREPARED BY

日期：22024. 2. 28

DATE:

FOSHAN SHUNDE YINGFUDA MICRO MOTOR CO., LTD

Product Specification

Version: A/0

Customer		Model	D3045D24-Q227	Rated Voltage	24VDC
1、Electrical Characteristics (Current Unit:A .Speed Unit:RPM.)					
Items of Inspection	Electrical Characteristics Standards	AQL Level		Measurement & Tools	Remarks
No Load Current	≤0.45A	II	0.65	DC Power Supply,Tachometer, Electric Motor Performance Analysier	— —
No Load Speed	2800-3200rpm	II	0.65		
No Load Power		II	0.65		DC24.0V 电机运转顺畅
Reduced Voltage Starting		II	0.65		
HI-POT Test	500VAC/2mA/1Sec	S-4	0	Hi-pot tester	— —
Amplitude	By Tactile feel	S-4	0.65	By Tactile feel	Tactile feel after motor operated 15s
Noise	≤50dB(A)	S-4	0.65	Decibel Meter	Microphone at 30 cm aligned on the motor
Direction of Rotation	CCW&CW	II	0	By View	CCW when viewed from output shaft side.
Rating Spark test	≤1.5 operated at no load	II	0.65	By View	— —
Rated load current		II	0.65		— —
Rated load speed		II	0.65		
Rated load power		II	0.65		
Remarks:					

2、Mechanical Characteristics(Unit: mm)					
Items of Inspection	Mechanical Characteristics Standards	AQL Level		Measurement & Tools	备注
Shaft	Smooth without Scratches, deformations	S-4	0.65	By View	
Runout of Shaft Extension (mm)	30.2±0.5	S-4	0.65	Dial Gauge	
End Play(mm)	0.1	S-4	0.65	Dial Gauge	
3、Outline					
Items of Inspection	Outline Standards		AQL Level		Measurement & Tools
Shaft	Smooth without scratches, Corrosions		II	1.0	By View
Ball Bearing Housing	Burst, rough edges		II	1.0	By View
Laser Marks	Clear Texture,		II	1.0	By View
Others	Rotor spin smooth without locked,		II	1.0	By Tactile feel
4、Pacakage					
Items of Inspection	Package standards				Measurement & Tools
Packing	Places motors to each container in total 12pcs in a group,84 groups align gently				By View
Package	Marks Clear、Keep Clean、				By View

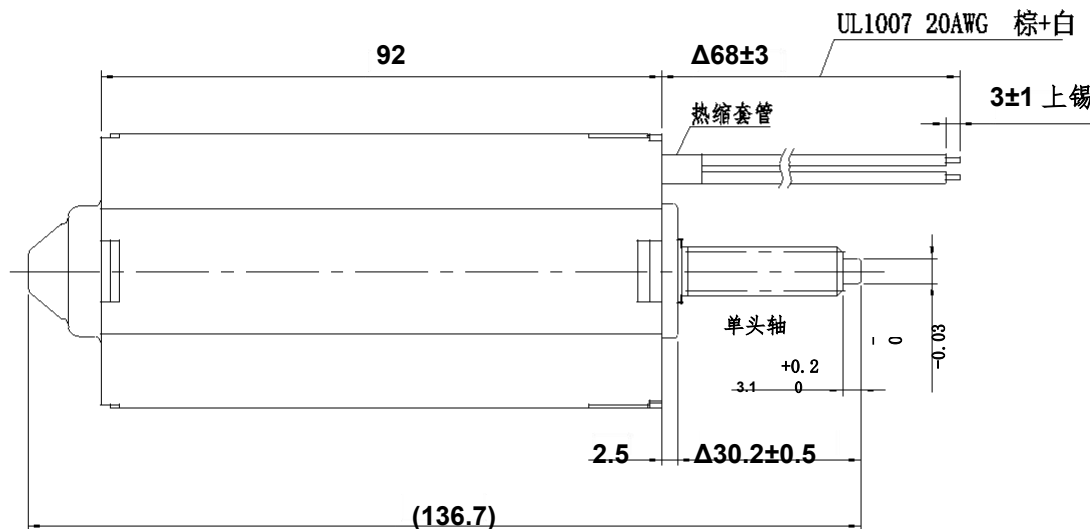
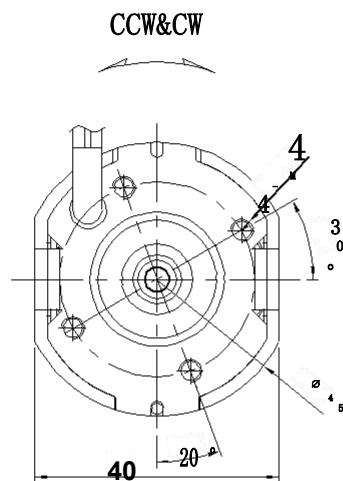

技术要求:

1.额定电压: 24VDC(端电压)

2.转向: 棕“+”白“-”轴伸端 CCW

3.空载性能:

电流: 0.45A MAX 转速:2800-3200RPM

4.电机外观良好, 无裂纹、锈蚀、碰伤、污迹等不良

5.耐压:500VAC/2mA/1S

6."Δ"为关键控制项目或尺寸。

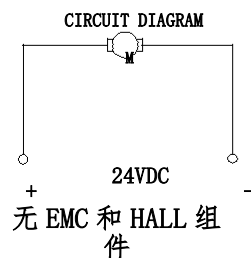

TITLE: 外形图		TOLERANCES		VERSION	A
		>0-6.0	±0.10		
		>6.0-30.0	±0.15	PAPER SIZE	A4
		>30.0-120.0	±0.25	SCALE:	NO SCALE
MATERIAL:	MODEL: D3045D24-Q227	ANGLE		UNITS	mm
		DATE	28/2-24		
PART NO.:		DSGN BY	YWjiang		
		CHKD BY			
		APRD BY			
		PIE BY			
盈富达微电机有限公司		QA BY			